

# CL1 Chlorinator

## Owner's Manual



CL1-9OFF | CL1-9ON  
CL1-42OFF | CL1-42ON



Scan to register your  
product warranty

# GoPool

## Warranty registration

Thank you for choosing GoPool! Register your product today to activate your warranty and get quick, hassle-free support when you need it.



Scan to register your product warranty



**WARNING**

This equipment must be installed and serviced according to the information found in this manual. Improper installation can create hazards which could result in property damage, serious injury or death. Improper installation will void the warranty.

## Table of contents

|                             |   |
|-----------------------------|---|
| Installation.....           | 1 |
| Directions for use .....    | 4 |
| Maintenance .....           | 6 |
| Pump structure & parts..... | 7 |

01. Your **CL1-90N** and **CL1-420N** automatic chlorine feeders are designed for permanent installation in the pool water return line.

02. Always install the chlorine feeder after the heater. If there is no heater, it should be installed after the filter to avoid potential damage. Allowing concentrated chlorine to flow through the heater or filter can cause damage to these components.

03. The **CL1-90N** and **CL1-420N** are equipped with 1 1/2 inch female threads, while the **CL1-90N** model features male threads. If male and union connections are required, you can order the S182 PVC male union connector package. Alternatively, thread or socket adapters can also be used. When making connections, only use pipe sealants specifically formulated and approved for ABS plastic. It is important not to overtighten the pipe fitting—tighten it by hand, then add 1 to 1 1/2 additional turns at most to ensure a proper fit.

**NOTICE:** After starting the system, re-check all connections for leaks. Retighten as required.

**Refer to Section II: DIRECTIONS FOR USE.**

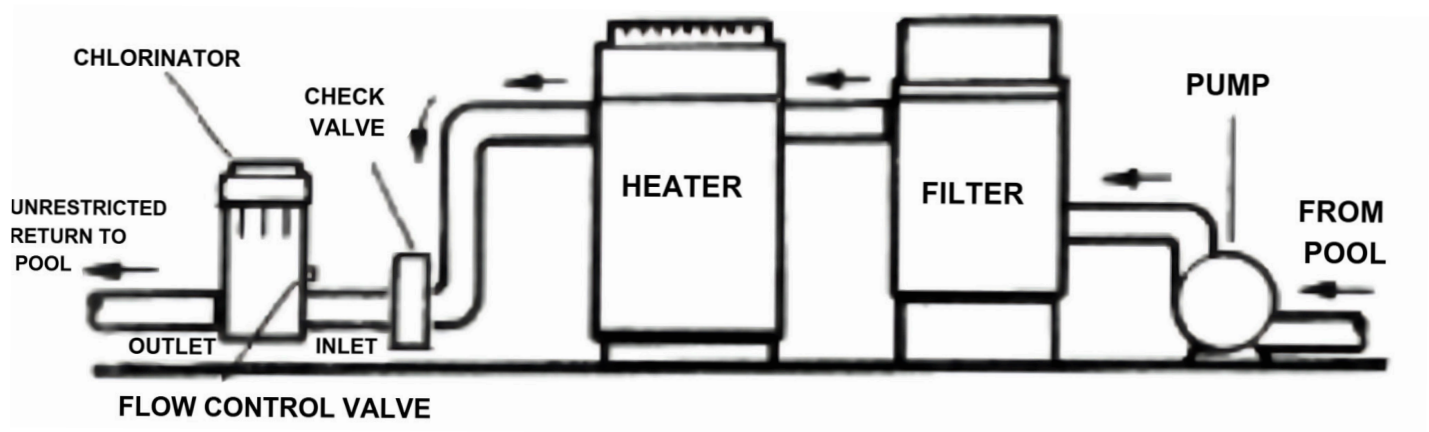

**NOTE -**

Never install the chlorine feeder directly into copper plumbing, as it may cause pipe damage. If you have brass or bronze backwash valves or other sensitive metallic components, consult your dealer for precautions or recommendations specific to your system.

## CL1-420FF, CL1-90FF

### 01. Planning installation

- 1) The inlet connection should be made in the piping after the pump and before the filter. Mark the location on the pipe.
- 2) The outlet connection should be made in the piping after the heater. If no heater is being used, the connection should be made after the filter. Mark the location on the pipe.
- 3) Based on the locations from Steps 1 and 2, cut the tubing to the required lengths. Ensure that the ends are cut evenly and cleanly.

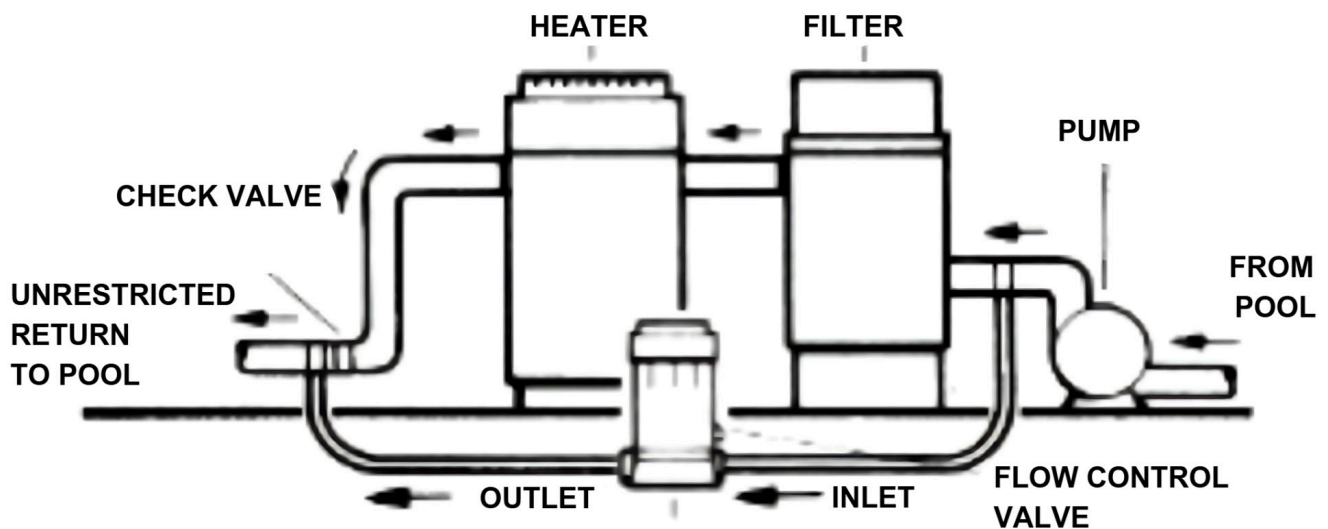

#### NOTE -

Never install the chlorine feeder directly into copper plumbing, as it may cause pipe damage. If you have brass or bronze backwash valves or other sensitive metallic components, consult your dealer for precautions or recommendations specific to your system.

## 02. Connection to chlorinator

- 1) Wrap **Teflon** tape around the larger male thread of the Check Valve and thread it securely into the outlet port of the chlorinator.

**NOTICE:** The Check Valve is marked with a “dot” and contains a ball that “clicks” when shaken.

- 2) Wrap **Teflon** tape around the large male thread of the inlet fitting adapter and thread it securely into the inlet port of the chlorinator.
- 3) To connect inlet tubing to the chlorinator, place the compression nut over the inlet tubing and tighten it about 2 inches. Insert the tubing all the way into the inlet fitting adapter socket and, holding the tubing in place, tighten the nut firmly by hand. Do not overtighten.
- 4) Connect the outlet tubing to the Check Valve in the same manner as **Step 3**.

## 03. Connection to plumbing lines

**NOTICE:** The Saddle Fittings and clamps are designed to fit the O.D. of 1 1/2” or 2” pipe.

- 5) Drill a 3/8” hole at the location identified in **Step 1** of the Planning Installation section. Clean all burrs, shavings, etc. Fit the Saddle Fitting, with gasket, into the oval-shaped hole in the clamp, and insert the fitting into the 3/8” hole. Secure the clamp around the Saddle Fitting, gasket, and pipe, and tighten securely to achieve a good seal. Do not overtighten the clamp.
- 6) Drill a 3/8” hole at the location identified in **Step 2** of the Planning Installation section. Install the Saddle Fitting as in **Step 5**.
- 7) Connect the inlet and outlet tubing to the Saddle Fittings with compression nuts, as in **Step 3**. Do not overtighten.

**NOTICE:** After starting the system, re-check all connections for leaks. Retighten as required.



## General information

Before using your chlorinator, ensure your pool or spa water is properly balanced, conditioned, and maintains a chlorine residual of approximately 1.0 to 1.5 ppm. Always follow the directions provided by your dealer and chemical manufacturer.

- Check chlorine residual daily.
- Adjust the dial valve as needed to increase or decrease chlorine levels.
- Chlorine demand varies based on factors such as usage, temperature, and sunlight. Initially, some trial and error may be necessary to determine the appropriate chlorine amount and valve setting for your pool's filtration cycle.
- Always refer to the chemical manufacturer's guidelines for maintaining proper chlorine levels.

## Refilling the chlorinator

### **DANGER:**

- Use **only** 3-inch diameter, **slow-dissolving** Trichloro-S-Triazinetrione chlorine tablets.
- **Never** use fast-dissolving Trichloro-S-Triazinetrione chlorine tablets.
- **Never** mix chemicals, as this may cause fire and/or explosion.
- **Never** mix Trichloro-S-Triazinetrione chlorine tablets with Calcium Hypochlorite, other forms of concentrated chlorine, or any other chemicals—this can result in fire or explosion.
- **Never** add any other chlorine types, pH adjusters, shock treatments, or algaecides through the skimmer. These products must be added directly to the pool water.
- **Never** isolate the chlorine feeder with a valve or other devices.

### **WARNING:**

- Read and follow all safety instructions before operating or servicing the chlorine feeder.
- To reduce the risk of injury, **do not allow children to use this product.**
- Wear **eye and skin protection** while maintaining or servicing the unit.
- Avoid inhaling fumes from the chlorinator or chemical container.
- Chlorine feeder may be under pressure—**use caution when removing the cover.**

## **Steps for Refilling the Chlorinator :**

- 1) Shut off all pumps and pump timers.
- 2) Turn the chlorine feeder flow control valve to "OFF".
- 3) Ensure that the chlorine feeder return line to the pool is unrestricted.
- 4) Wait one minute to relieve system pressure before attempting to remove the cover.
- 5) Remove the cover.
- 6) Refill the chlorine feeder with only 3-inch diameter, slow-dissolving Trichloro-S-Triazinetrione chlorine tablets.
- 7) Secure the cover back onto the chlorine feeder.
- 8) Turn the flow control valve to the desired setting and restart the pump.

## 01. To change O-ring

### CL1-42OFF / CL1-42ON

- 1) Read and follow the instructions in **Steps 1 to 5** in the Refilling Chlorinator section.
- 2) Remove the O-Ring and replace it with a Splash replacement O-Ring (part no. S067K).
- 3) Replace the cover. If the chlorinator needs to be refilled, read and follow the instructions in **Steps 6 to 8** in the Refilling Chlorinator section.

### CL1-90OFF/ CL1-90N

- 1) Read and follow the instructions in **Steps 1 to 5** in the Refilling Chlorinator section.
- 2) Replace the O-Ring with a Splash replacement O-Ring (part no. S068K). Reassemble, ensuring the slip washers are in place on the stem of the cover (inside).
- 3) Replace the cover. If the chlorinator needs to be refilled, read and follow the instructions in **Steps 6 to 8** in the Refilling Chlorinator section.

## 02. To remove flow control valve handle

- Set the pointer to «FULL.» Insert a screwdriver in the slot opposite the pointer, lift up, and rotate the handle counterclockwise. This will allow the handle index lock tab to clear the body ridge.

## 03. Winterizing

- Where freezing temperatures can be expected, drain all water from the chlorinator. (For in-line, permanently installed units, remove the drain plug.) Carefully remove any undissolved tablets and rinse out the chlorinator thoroughly with water. Replace the cover and drain plug.

## 04. Vacuuming

- When vacuuming, close the flow control valve to prevent bypass of sediment and possible clogging of the control valve.

## 05. Lubrication

- Never use petroleum-type lubricants on the cover O-Ring. To lubricate, use Jack's No. 327 lube only.



# Pump structure & parts



## CL1-42ON SERIES

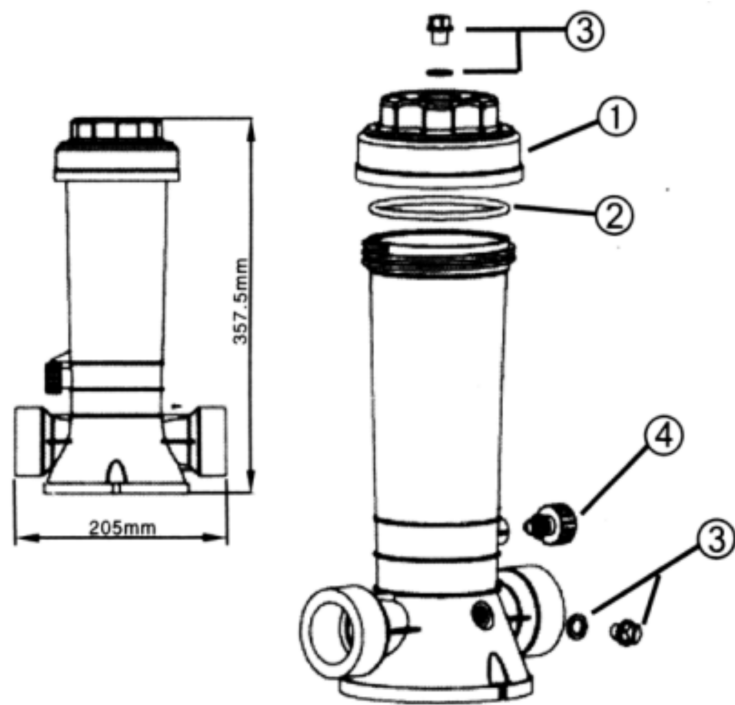

| Ref. No. | Part No.     | Description            | Quantity |
|----------|--------------|------------------------|----------|
| 1        | 647016703080 | Cover                  | 1        |
| 2        | 65431033080  | O-ring                 | 1        |
| 3        | 88601004     | Drain Plug w/Gasket    | 2        |
| 4        | 647016875000 | Control Valve Assembly | 1        |

# Pump structure & parts



## CL1-42OFF SERIES

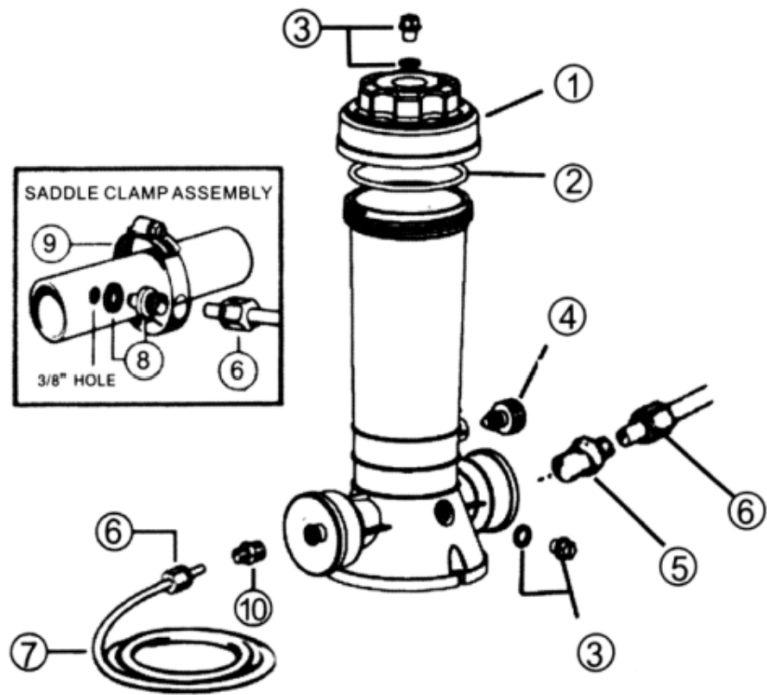

| Ref. No. | Part No.     | Description            | Quantity |
|----------|--------------|------------------------|----------|
| 1        | 647016703080 | Cover                  | 1        |
| 2        | 65431033080  | O-ring                 | 1        |
| 3        | 88601004     | Drain Plug w/Gasket    | 2        |
| 4        | 647016875000 | Control Valve Assembly | 1        |
| 5        | 647016807080 | Inlet Fitting Adapter  | 2        |
| 6        | 647016806001 | Compression Nuts       | 4        |
| 7        | 65749011080  | Plastic Tubing - 8 ft. | 1        |
| 8        | 647016805080 | Saddle Fitting         | 2        |
| 9        | 65021013000  | Saddle Clamp           | 2        |
| 10       | 647016873000 | Check Valve Assembly   | 1        |

# Pump structure & parts



## CL1-9ON SERIES

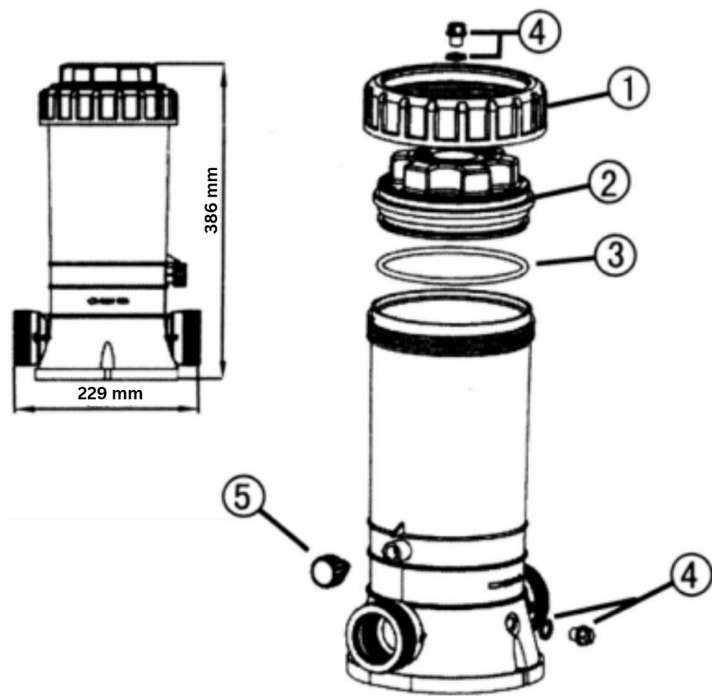

| Ref. No. | Part No.     | Description            | Quantity |
|----------|--------------|------------------------|----------|
| 1        | 647016803080 | Cover Cap              | 1        |
| 2        | 647016802000 | Cover                  | 1        |
| 3        | 65431036080  | O-Ring                 | 1        |
| 4        | 88601004     | Drain Plug w/Gasket    | 2        |
| 5        | 647016875000 | Control Valve Assembly | 1        |

# Pump structure & parts



## CL1-9OFF SERIES

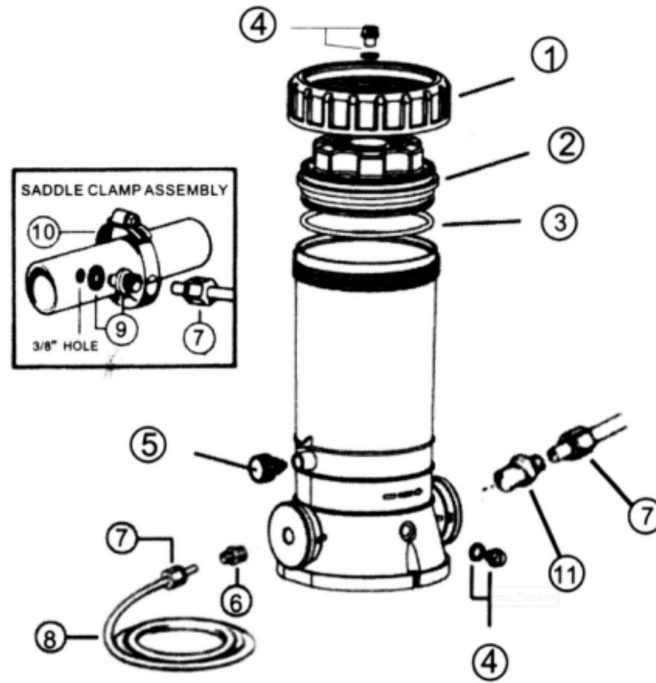

| Ref. No. | Part No.     | Description            | Quantity |
|----------|--------------|------------------------|----------|
| 1        | 647016803080 | Cover Cap              | 1        |
| 2        | 647016802000 | Cover                  | 1        |
| 3        | 65431036080  | O-Ring                 | 1        |
| 4        | 88601004     | Drain Plug w/Gasket    | 2        |
| 5        | 647016875000 | Control Valve Assembly | 1        |
| 6        | 647016807080 | Inlet Fitting Adapter  | 2        |
| 7        | 647016806001 | Compression Nuts       | 4        |
| 8        | 65749011080  | Plastic Tubing - 8 ft. | 1        |
| 9        | 647016805080 | Saddle Fitting         | 2        |
| 10       | 65021013000  | Saddle Clamp           | 2        |
| 11       | 647016873000 | Check Valve Assembly   | 1        |

Use only GoPool genuine replacement parts.

# GoPool

Need parts or accessories ?  
[GoPool.com](http://GoPool.com)